

105 DT 26 72 SF 8Ω

812687

High-end dome tweeter with exposed fabric dome designed to give maximum dispersion and openness in the sound. It has an aluminium flange which gives maximum stiffness. As can be seen from the frequency response and the difference tone distortion curves this is a tweeter with a smooth and clean sound. We recommend this unit for use in any demanding hi-fi system.

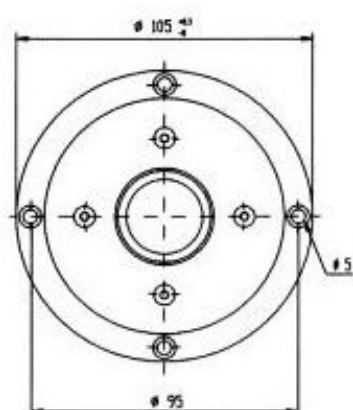

DT 105

Thiele Small parameters:

Nominal impedance	Zn (Ω)	8
Minimum impedance/at freq.	Zmin (Ω/Hz)	7.2 / 4100
Maximum impedance	Zo (Ω)	31.0
Dc resistance	Re (Ω)	6.8
Voice coil inductance	Le (mH)	0.1
Resonance Frequency	fs (Hz)	1010
Mechanical Q factor	Qms	4.79
Electrical Q factor	Qes	1.35
Total Q factor	Qts	1.05
Mechanical resistance	Rms (Kg/s)	0.40
Moving mass	Mms (g)	0.30
Suspension compliance	Cms (mm/N)	0.08
Effective cone diameter	D (cm)	2.8
Effective piston area	Sd (cm ²)	6.2
Force factor	Bl (N/A)	3.1
Reference voltage sensitivity Re 2.83V 1m at 4100 Hz (Measured)	(dB)	90.5

Magnet and voice coil parameters:

Voice coil diameter	d (mm)	26
Voice coil length	h (mm)	1.6
Voice coil layers	n	2
Flux density in gap	B (T)	1.5
Total useful flux	(mWb)	0.3
Height of the gap	hg (mm)	2.5
Diameter of magnet	dm (mm)	72
Height of magnet	hm (mm)	15
Weight of magnet	(kg)	0.24

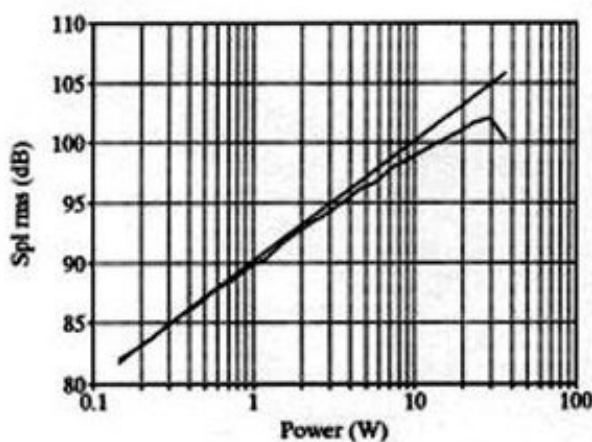
Max linear SPL:**Power handling**

Longterm Max System Power (IEC) (W) 130

